



Construction and working characteristics

- Accurate capacity to maintain set pressure.
- Sensitivity combined with high relieving rates.
- High flow rate with extremely low pressure drop.
- Pressure adjusting lockable handle by simply pressing it downwards in the desired position.
- Body made with anodized zoll aluminium alloy
- Two pressure gauge connections with plug complete of seal.
- Ring nut for panel mounting.

Technical characteristics

Connections	G 1/4"
Max. inlet pressure	10 bar - 1 MPa
Max. ambient temperature	50°C
Pressure gauge connections	G 1/8"
Weight	gr. 520
Pressure range	0,1 - 2 bar
	0,1 - 4 bar
	0,1 - 7 bar
Assembly position	Any
Air flow (inlet pressure 10 bar)	5 NI/min
Max. fitting torque	40 Nm

Ordering code

17212A .

Adjusting range
 A = 0,1 - 2 bar
 B = 0,1 - 4 bar
 C = 0,1 - 7 bar

Example: 17212A.C
 Pressure regulator with G 1/4" 0,1 - 7 bar

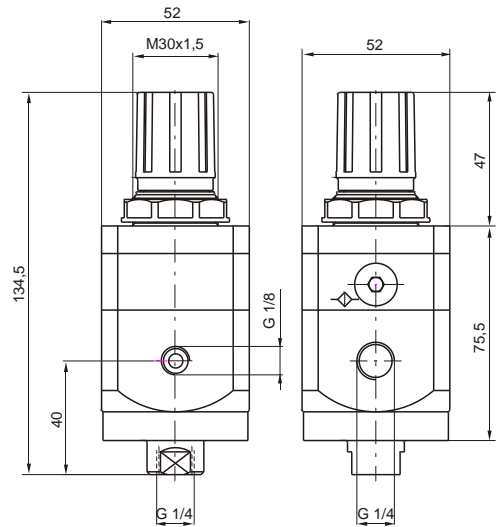

Flow rate curves (17212A.C)
 Inlet pressure (7 bar)

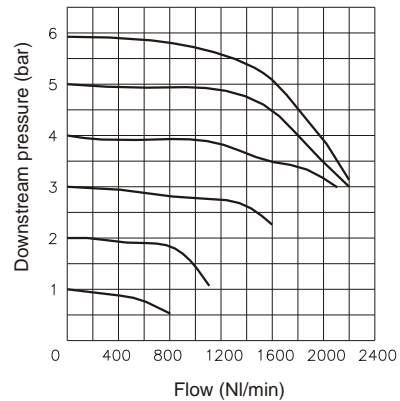

Adjustment characteristics (17212A.C)

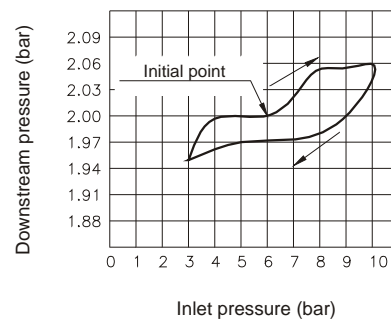

Exhaust flow rate curves (17212A.C)

