

## Construction and working characteristics

- Filter - diaphragm pressure regulator with relieving.
- Balanced poppet.
- Double filtering action: by air centrifuging and by replaceable and reusable HDPE porous filter element.
- Zinc alloy body or reinforced tecnopolymer body with threaded brass insert connections.
- Wall mounting possibility with M4 screws protected by covers.
- Handle lockable in the desired position by simply pressing it downwards.
- Transparent tecnopolymer bowl screwed to the body.
- Technopolymer shock resistant bowl protection.
- Manual and semi-automatic water drain valve; in the semi-automatic version the drainage happens when there is no pressure or by pushing the valve up-wards.
- Possibility to see the water level on 360° also with bowl protection assembled.
- Two pressure gauge connections with plug complete of seal.
- Panel mounting bracket.
- Automatic water drainage bowl available on request.

## Technical characteristics

Connections	G 1/8" - G 1/4"
Max. inlet pressure	13 bar - 1,3 MPa
Max. ambient temperature (at 10 bar)	50°C
Pressure gauge connections	G 1/8"
Weight with technopolymer body	gr. 180
Weight with zinc alloy body	gr. 295
Pressure range	0 - 2 bar 0 - 4 bar 0 - 8 bar 0 - 12 bar
Filter pore size	5µ 20µ 50µ
Bowl capacity	17 cm <sup>3</sup>
Assembly position	Vertical
Wall mounting screws	M4
Max. fitting torque on zinc alloy body	30 Nm
Max. fitting torque on technopolymer body	15 Nm

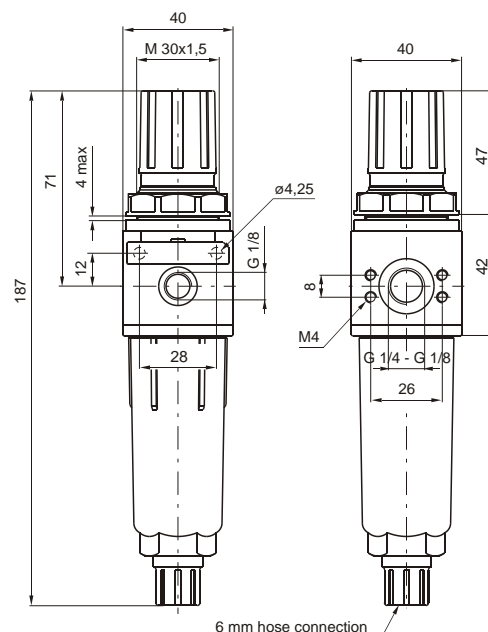

Flow rate curves  
Inlet pressure (7 bar)

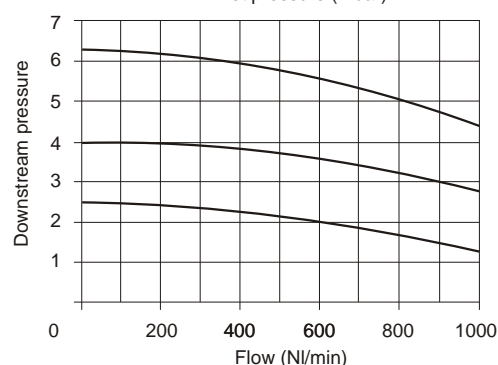

### Adjustment characteristics

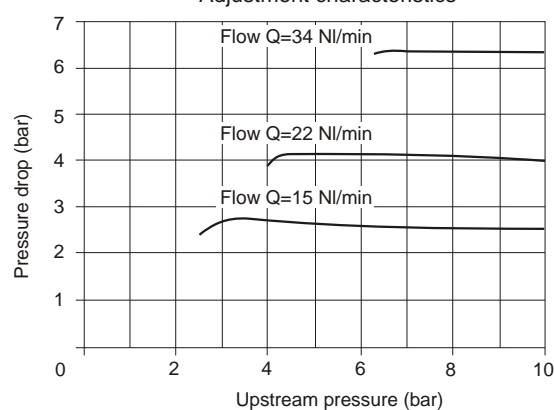

## Ordering code

17 04

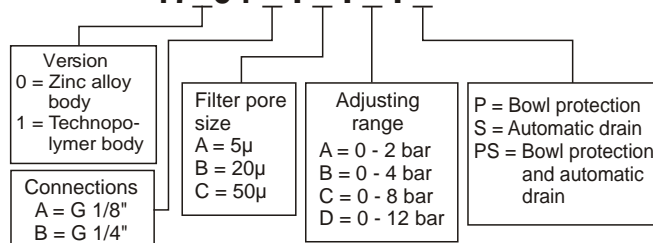

Example: 17104A.B.C.P

Filter - pressure regulator size 1 with G 1/8" connections, filter pore 20µ adjusting range 0 - 8 bar and bowl protection with technopolymer body.