



Anello spingitore in RESINA ACETALICA.  
Thrust ring (synthetic material).

Distanziale in RESINA ACETALICA.  
Block ring (synthetic material).

Pinza di nuova concezione in  
acciaio inox.  
Garantita la tenuta stabile del tubo.  
Ridotti al minimo gli ingombri del  
raccordo.  
New design stainless steel clamp.  
Permanent pipe seal guaranteed.  
Fitting dimensions reduced to a  
minimum.

Anello raccordo in RESINA ACETALICA.  
Distance ring (synthetic material).

Corpo di ottone nichelato.  
Nickel-plated brass body.

O-Ring in NBR priva di silicone.  
Silicone-free NBR O-Ring.

Superficie a misura delle lamiere  
di valvole e cilindri.  
Exact valve and cylinder spot-facing  
surfaces.

Tenuta con O-Ring fornito di propria  
sede.  
Facilitata l'ermeticità anche con  
superfici non levigate.  
O-Ring seals with own seat.  
Improved seal even with unpolished  
surfaces.

Filettatura da M5 a 1/2".  
Threading from M5 to 1/2".

Esagono interno, facilitato il  
montaggio con spazi esigui.  
Internal hexagon to facilitate  
assembly in limited spaces.

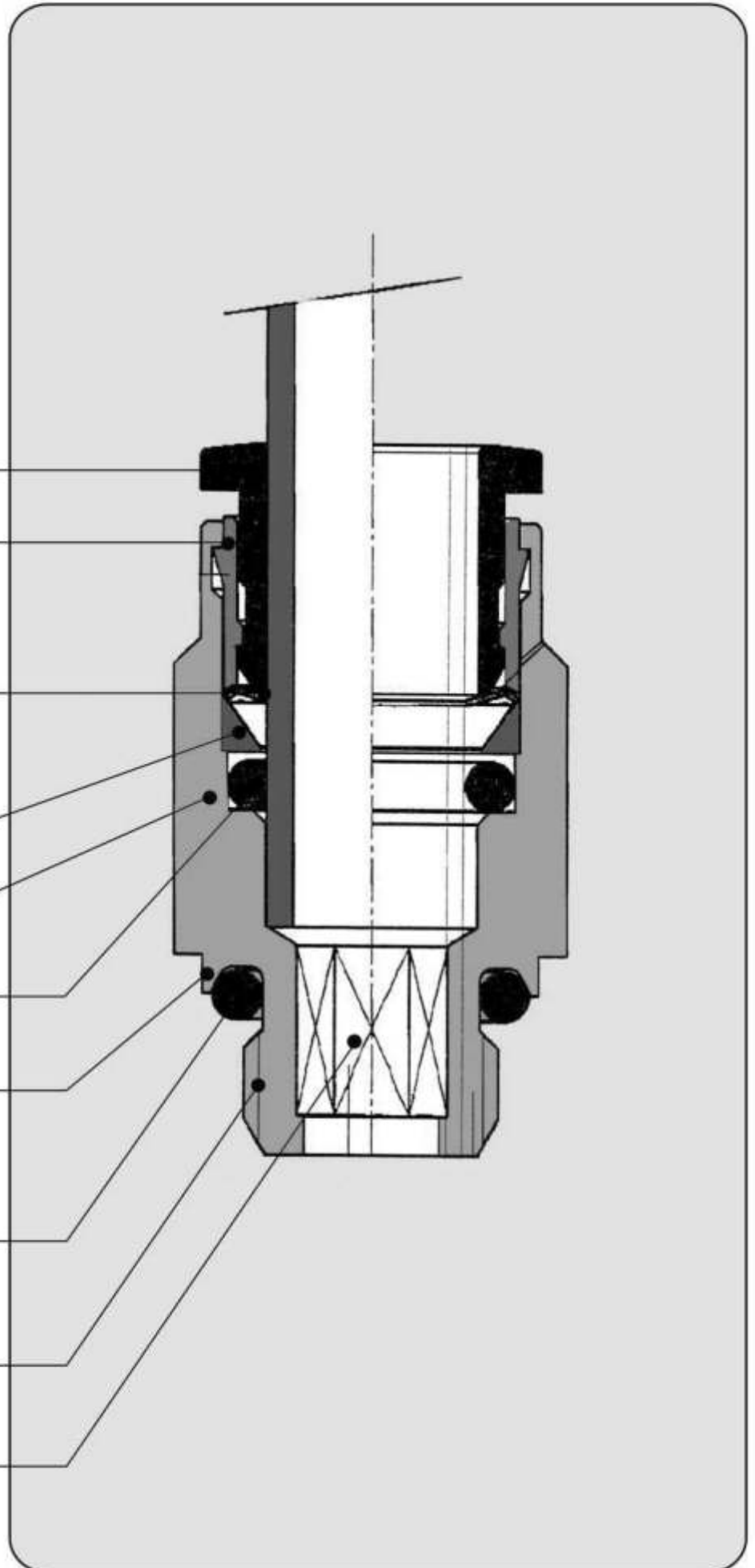



## DATI TECNICI DEI RACCORDI AUTOMATICI

Ø esterno tubo mm	Ø interno tubo mm	Pressioni di esercizio in bar dei raccordi con tubi per aria standard		
		-20°C	+31°C	+51°C
		+30°C	+50°C	+70°C
4	2	18	18	18
5	3	18	18	18
6	4	18	15	15
8	6	15	15	11
10	8	14	12	8
12	10	14	12	8
14	12	12	10	6

TOLLERANZE AMMESSE NEI TUBI		
Ø esterno tubo	tolleranze sul Ø esterno	
da 4 a 5 mm	+0,05	-0,08
da 6 a 14 mm	+0,05	-0,1

TUBI IN POLIURETANO		
Ø esterno tubo	tolleranze sul Ø esterno	
da 4 a 14 mm	+0,15	-0,1

## TECHNICAL DATA FOR PUSH-IN FITTINGS

Outside pipe diameter mm	Inside pipe diameter mm	Working pressure in bar tested with standard air hoses		
		-20°C	+31°C	+51°C
		+30°C	+50°C	+70°C
4	2	18	18	18
5	3	18	18	18
6	4	18	15	15
8	6	15	15	11
10	8	14	12	8
12	10	14	12	8
14	12	12	10	6

TOLERANCES FOR Pa11 AND Pa12 PIPES (Polyamide)		
Outside pipe diameter	Outside pipe diameter tolerance	
4 and 5 mm	+0,05	-0,08
from 6 to 14 mm	+0,05	-0,1

TOLERANCES FOR POLYURETHANE (PU) PIPES		
Outside pipe diameter	Outside pipe diameter tolerance	
from 4 to 14 mm	+0,15	-0,1

### DATI TECNICI

Temperature di utilizzo:	-20°C +70°C
Fluido:	Aria compressa (altri fluidi a richiesta)
Materiali:	Corpo ottone nichelato Guarnizioni NBR esente da silicone Molla in acciaio AISI 304 Anello spingitore in Resina Acetalica
Filettatura:	Cilindrica BSP con O-Ring

### CARATTERISTICHE PRINCIPALI

- 1 Passaggio pieno della portata
- 2 Aggancio automatico
- 3 Utilizzazione con i tubi Rilsan, Poliuretano, Nylon, Polietilene
- 4 Ingombri ridotti
- 5 Peso ridotto
- 6 Gamma modulare
- 7 Sede O-Ring sottotesta per tenuta su superfici piane
- 8 Atto a funzionare con il vuoto

### TECHNICAL DATA

Working temperature:	-20°C +70°C
Fluid:	Compressed air (other fluids on request)
Material:	nickel-plated brass body Silicone-free NBR gaskets AISI 304 stainless steel clamp Synthetic material ring
Threading:	Cylindrical BSP with O-Ring

### MAIN FEATURES

- 1 Full flow
- 2 Can be inserted and extracted with one hand
- 3 Suitable for tubes Rilsan, Polyurethane, Nylon, Polyethylene
- 4 Supercompact
- 5 Extremely lightweight yet sturdy
- 6 Modular assembly for complex pipe systems
- 7 O-Ring provided with his own seat to ensure seal with polished surfaces
- 8 Suitable for vacuum application

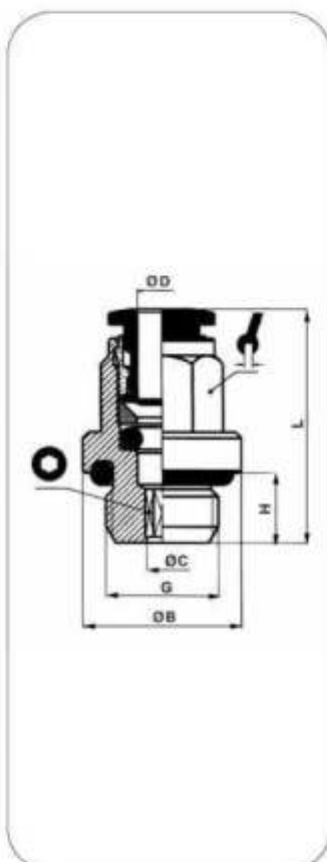

### ART. 01 Diritto filetto cilindrico maschio con O-Ring Straight male adaptor (parallel)

CODICE	ØD	G	ØC	ØB	H	L			
0104M5	4,0	M5	2,6	9,0	5,0	20,5		2,5	50
010418	4,0	G <sub>1/8</sub>	2,6	13,5	6,0	20,0	9,0	2,5	50
010414	4,0	G <sub>1/4</sub>	2,6	17,0	8,0	21,0	9,0	2,5	50
0105M5	5,0	M5	2,6	10	4,0	22,0		2,5	50
010518	5,0	G <sub>1/8</sub>	4,2	13,5	6,0	22,0	10,0	4,0	50
010514	5,0	G <sub>1/4</sub>	4,2	17,0	8,0	22,0	10,0	4,0	50
0106M5	6,0	M5	2,6	11,0	4,0	22,8		2,5	50
010618	6,0	G <sub>1/8</sub>	4,2	13,5	8,0	25,3	11,0	4,0	50
010614	6,0	G <sub>1/4</sub>	4,2	17,0	8,0	24,3	11,0	4,0	50
010818	8,0	G <sub>1/8</sub>	5,2	12,8	6,0	27,0	13,0	5,0	50
010814	8,0	G <sub>1/4</sub>	6,2	17,0	8,2	25,5	13,0	6,0	50
010838	8,0	G <sub>3/8</sub>	6,2	20,0	9,0	25,5	13,0	6,0	50
011014	10,0	G <sub>1/4</sub>	7,3	16,0	8,0	30,4	16,0	7,0	50
011038	10,0	G <sub>3/8</sub>	8,3	21,0	9,0	30,9	16,0	8,0	50
011214	12,0	G <sub>1/4</sub>	7,3	16,0	8,0	33,2	19,0	7,0	25
011238	12,0	G <sub>3/8</sub>	10,3	22,0	9,0	33,2	19,0	10,0	25
011212	12,0	G <sub>1/2</sub>	10,3	24,0	11,0	33,2	19,0	10,0	25
011438	14,0	G <sub>3/8</sub>	10,3	21,0	9,0	35,0	21,0	10,0	25
011412	14,0	G <sub>1/2</sub>	10,3	24,0	11,0	32,5	21,0	10,0	25

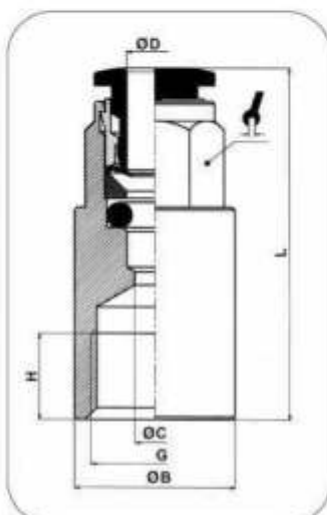

### ART. 02 Diritto femmina Straight female adaptor

CODICE	ØD	G	ØC	ØB	H	L			
020418	4,0	G <sub>1/8</sub>	3,0	12,0	6,5	26,5	9,0		50
020414	4,0	G <sub>1/4</sub>	3,0	17,0	10,0	29,5	9,0		50
020518	5,0	G <sub>1/8</sub>	4,0	12,0	6,5	27,0	10,0		50
020514	5,0	G <sub>1/4</sub>	4,0	17,0	10,0	30,0	10,0		50
020618	6,0	G <sub>1/8</sub>	5,0	12,0	6,5	28,3	11,0		50
020614	6,0	G <sub>1/4</sub>	5,0	17,0	10,0	31,3	11,0		50
020818	8,0	G <sub>1/8</sub>	7,0	12,0	6,5	28,5	13,0		50
020814	8,0	G <sub>1/4</sub>	7,0	17,0	10,0	32,5	13,0		50

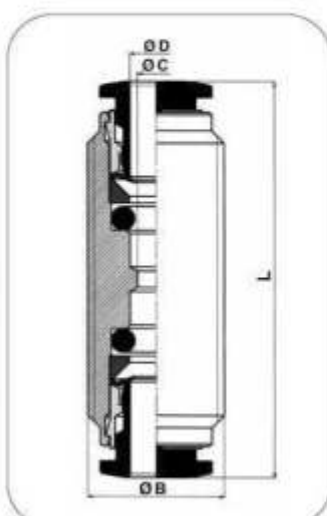

### ART. 03 Intermedio Straight connector

CODICE	ØD	ØC	ØB	L	
030400	4,0	3,0	M11	32,0	50
030500	5,0	4,0	M12	33,0	50
030600	6,0	5,0	M14	36,1	50
030800	8,0	7,0	M16	38,0	50
031000	10,0	9,0	M18	42,3	50
031200	12,0	11,0	M22	45,8	25
031400	14,0	13,0	M24	47,5	25

**ART. 04****Gomito innestabile  
Elbow connector**

CODICE	ØD	ØC	ØB	L	
040400	4,0	3,0	9,0	17,3	50
040500	5,0	4,0	10,0	19,0	50
040600	6,0	5,0	11,0	20,6	50
040800	8,0	7,0	13,0	23,0	50
041000	10,0	8,0	16,0	26,4	50
041200	12,0	10,0	19,0	28,9	25
041400	14,0	12,0	21,0	31,5	25

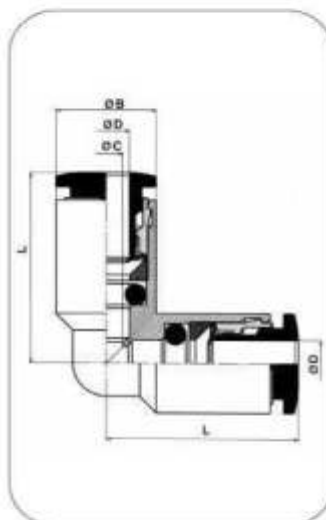
**ART. 05****T innestabile  
T connector**

CODICE	ØD	ØC	ØB	L	
050400	4,0	3,0	9,0	17,3	50
050500	5,0	4,0	10,0	19,0	50
050600	6,0	5,0	11,0	20,6	50
050800	8,0	7,0	13,0	23,0	50
051000	10,0	8,0	16,0	26,4	20
051200	12,0	10,0	19,0	28,9	25
051400	14,0	12,0	21,0	31,5	20

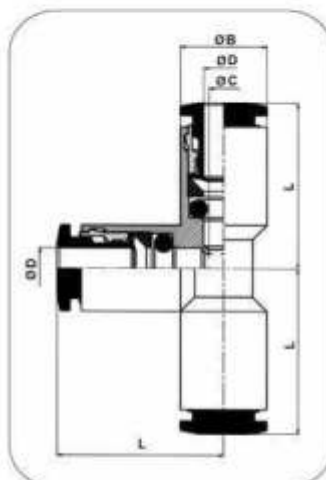
**ART. 06****Innesto, filetto cilindrico con O-Ring  
Adaptor parallel (short)**

CODICE	ØD	G	ØC	ØB	H	L	ØA		
0604M5	4,0	M5	2,0	8,0	4,0	24,2	8,0	50	
060418	4,0	G <sub>1/8</sub>	2,0	13,0	6,0	27,7	6,0	13,0	50
060414	4,0	G <sub>1/4</sub>	2,0	16,0	8,0	30,2	7,5	13,0	50
0605M5	5,0	M5	2,6	8,0	4,0	25,0	8,0	50	
060518	5,0	G <sub>1/8</sub>	3,0	13,0	6,0	28,5	6,0	13,0	50
060514	5,0	G <sub>1/4</sub>	3,0	16,0	8,0	31,0	7,5	13,0	50
0606M5	6,0	M5	2,6	8,0	4,0	26,0	8,0	50	
060618	6,0	G <sub>1/8</sub>	4,0	13,0	6,0	29,5	6,0	13,0	50
060614	6,0	G <sub>1/4</sub>	4,0	16,0	8,0	32,0	7,5	13,0	50
060818	8,0	G <sub>1/8</sub>	6,0	13,0	6,0	31,0	13,0	50	
060814	8,0	G <sub>1/4</sub>	6,0	16,0	8,0	33,5	7,5	13,0	50
060838	8,0	G <sub>3/8</sub>	6,0	20,0	9,0	35,5	9,0	13,0	50
061018	10,0	G <sub>1/8</sub>	6,0	13,0	6,0	35,5	13,0	50	
061014	10,0	G <sub>1/4</sub>	8,0	16,0	8,0	38,0	13,0	50	
061038	10,0	G <sub>3/8</sub>	8,0	20,0	9,0	41,0	13,0	50	
061214	12,0	G <sub>1/4</sub>	8,0	16,0	8,0	39,0	13,0	25	
061238	12,0	G <sub>3/8</sub>	10,0	20,0	9,0	42,0	11,0	13,0	25
061212	12,0	G <sub>1/2</sub>	10,0	24,0	11,0	44,0	13,0	16,0	25
061438	14,0	G <sub>3/8</sub>	12,0	20,0	9,0	44,5	16,0	25	
061412	14,0	G <sub>1/2</sub>	12,0	24,0	11,0	46,5	16,0	25	

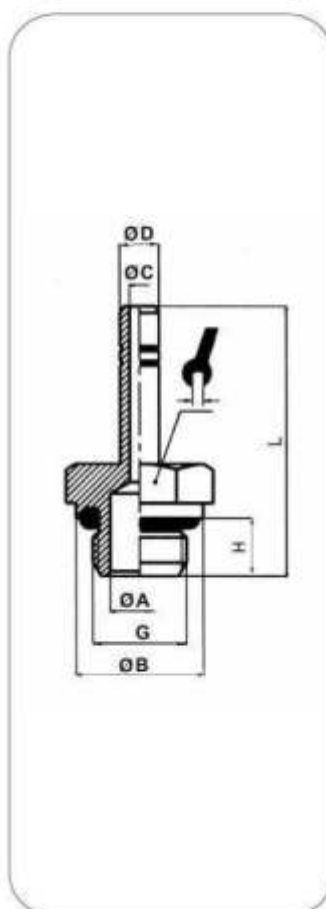

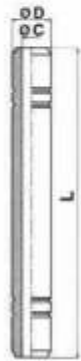

**ART. 07** Prolungamento  
Connector

CODICE	ØD	ØC	L	
070400	4,0	2,0	32,0	100
070500	5,0	3,0	33,0	50
070600	6,0	4,0	35,0	50
070800	8,0	6,0	38,0	50
071000	10,0	8,0	45,5	50
071200	12,0	10,0	48,0	25
071400	14,0	12,0	53,0	25

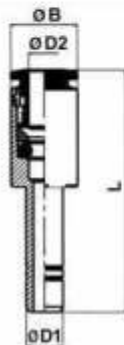

**ART. 08** Riduzione  
Reducer

CODICE	ØD1	ØD2	ØB	L	
080504	5,0	4,0	9,0	33,0	50
080604	6,0	4,0	9,0	31,0	50
080605	6,0	5,0	10,0	35,5	50
080804	8,0	4,0	9,0	32,5	50
080805	8,0	5,0	10,0	32,5	50
080806	8,0	6,0	11,0	34,8	50
081006	10,0	6,0	11,0	39,3	50
081008	10,0	8,0	13,0	39,0	50
081204	12,0	4,0	13,0	40,0	25
081206	12,0	6,0	13,0	40,3	25
081208	12,0	8,0	13,0	39,5	25
081210	12,0	10,0	16,0	42,4	25
081404	14,0	4,0	15,0	43,5	25
081406	14,0	6,0	15,0	43,8	25
081408	14,0	8,0	15,0	44,0	25
081410	14,0	10,0	16,0	44,9	25
081412	14,0	12,0	19,0	45,9	25

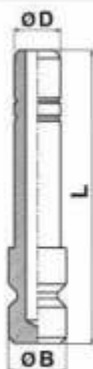

**ART. 08/E** Maggiorazione  
increaser

CODICE	ØD1	ØD2	ØB	L	
08E0406	4,0	6,0	11,0	35,5	50
08E0608	6,0	8,0	13,0	39	50



**ART. 09** Tappo  
Plug

CODICE	ØD	ØB	L	
090400	4,0	5,0	25,5	50
090500	4,9	6,0	26,5	50
090600	6,0	7,0	27,5	50
090800	8,0	9,0	30,0	50
091000	10,0	11,0	35,0	50
091200	12,0	13,0	37,0	25
091400	14,0	15,0	39,5	25

**ART. 10** Passaparete  
 Bulkhead connector

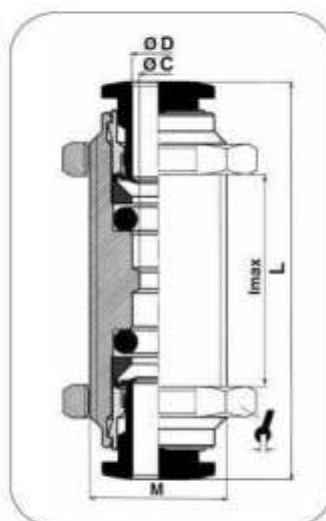
CODICE	ØD	ØC	M	l <sub>max</sub>	L		
100400	4,0	3,0	M11	8,0	32,0	14,0	50
100500	5,0	4,0	M11x1	8,0	33,0	14,0	50
100600	6,0	5,0	M14x1	8,0	36,1	17,0	50
100800	8,0	7,0	M16x1	10,0	38,0	19,0	50
101000	10,0	9,0	M18	12,0	42,3	21,0	25
101200	12,0	11,0	M22	17,0	45,8	20,0	25
101400	14,0	13,0	M24	18,0	47,5	27,0	25

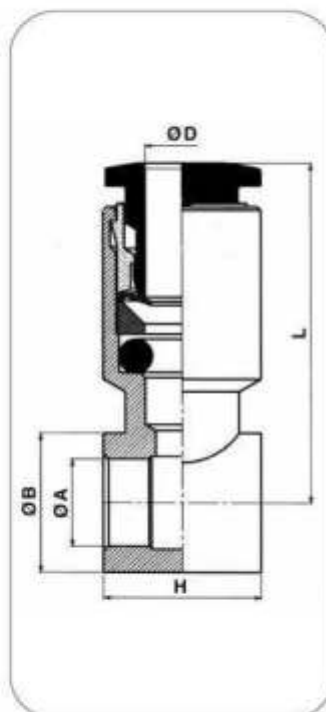

**ART. 13** Anello semplice  
 Single banjo body

CODICE	ØD	G	ØA	ØB	H	L	
1304M5	4,0	M5	5,0	8,0	9,0	19,5	50
130418	4,0	G <sub>1/8</sub>	9,9	14,0	15,0	21,1	50
1305M5	5,0	M5	5,0	8,0	9,0	19,8	50
130518	5,0	G <sub>1/8</sub>	9,9	14,0	15,0	22,5	50
130618	6,0	G <sub>1/8</sub>	9,9	14,0	15,0	24,3	50
130614	6,0	G <sub>1/4</sub>	13,3	18,0	17,0	25,5	50
130818	8,0	G <sub>1/8</sub>	9,9	14,0	15,0	24,8	50
130814	8,0	G <sub>1/4</sub>	13,3	18,0	17,0	26,5	50
130838	8,0	G <sub>3/8</sub>	16,75	21,0	20,0	28,0	50
131014	10,0	G <sub>1/4</sub>	13,3	18,0	17,0	28,4	50
131038	10,0	G <sub>3/8</sub>	16,75	21,0	20,0	29,9	25
131214	12,0	G <sub>1/4</sub>	13,3	18,0	17,0	30,4	25
131238	12,0	G <sub>3/8</sub>	16,75	21,0	20,0	31,4	25
131212	12,0	G <sub>1/2</sub>	21,0	26,0	24,0	34,9	25
131412	14,0	G <sub>1/2</sub>	21,0	26,0	24,0	35,5	25

**ART. 14** Anello doppio  
 Double banjo body

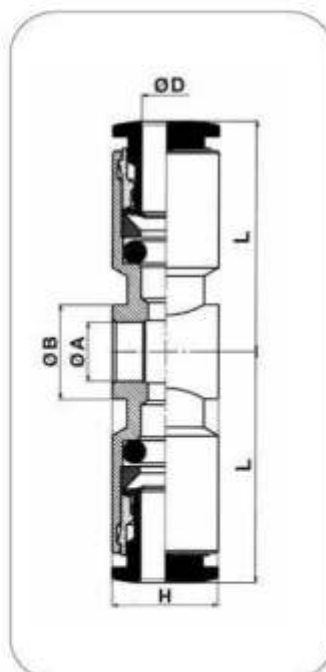
CODICE	ØD	G	ØA	ØB	H	L	
1404M5	4,0	M5	5,0	8,0	9,0	19,5	50
140418	4,0	G <sub>0.5</sub>	9,9	14,0	15,0	21,1	50
1405M5	5,0	M5	5,0	8,0	9,0	19,8	50
140518	5,0	G <sub>1/8</sub>	9,9	14,0	15,0	22,5	50
140618	6,0	G <sub>1/8</sub>	9,9	14,0	15,0	24,3	50
140614	6,0	G <sub>1/4</sub>	13,3	18,0	17,0	25,5	50
140818	8,0	G <sub>1/8</sub>	9,9	14,0	15,0	24,8	50
140814	8,0	G <sub>1/4</sub>	13,3	18,0	17,0	26,5	50
140838	8,0	G <sub>3/8</sub>	16,75	21,0	20,0	28,0	50
141014	10,0	G <sub>1/4</sub>	13,3	18,0	17,0	28,4	50
141038	10,0	G <sub>3/8</sub>	16,75	21,0	20,0	29,9	25
141214	12,0	G <sub>1/4</sub>	13,3	18,0	17,0	30,4	25
141238	12,0	G <sub>3/8</sub>	16,75	21,0	20,0	31,4	25
141212	12,0	G <sub>1/2</sub>	21,0	26,0	24,0	34,9	25

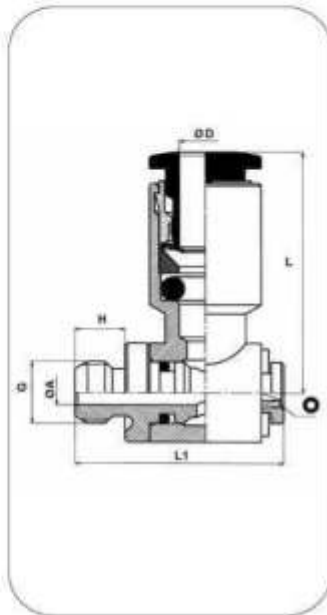

**ART. 15**

Asta con filetto maschio cilindrico in anello semplice  
Complete single banjo (rotating under pressure)

CODICE	ØD	G	ØA	H	L1	L	Ø	■
1504M5	4,0	M5	2,0	4,0	16,8	19,5	2,0	50
150418	4,0	G <sub>1/8</sub>	5,5	6,0	25,0	21,1	3,0	50
1505M5	5,0	M5	2,0	4,0	16,8	19,8	2,0	50
150518	5,0	G <sub>1/8</sub>	5,5	6,0	25,0	22,5	3,0	50
150618	6,0	G <sub>1/8</sub>	5,5	6,0	25,0	24,3	3,0	50
150614	6,0	G <sub>1/4</sub>	7,8	8,0	29,5	25,5	4,0	50
150818	8,0	G <sub>1/8</sub>	5,5	6,0	25,0	24,8	3,0	50
150814	8,0	G <sub>1/4</sub>	7,8	8,0	29,3	26,5	4,0	50
150838	8,0	G <sub>3/8</sub>	10,0	9,0	34,0	28,0	5,0	25
151014	10,0	G <sub>1/4</sub>	7,8	8,0	29,3	28,4	4,0	25
151038	10,0	G <sub>3/8</sub>	10,0	9,0	34,0	29,9	5,0	25
151214	12,0	G <sub>1/4</sub>	7,8	8,0	29,3	30,4	4,0	25
151238	12,0	G <sub>3/8</sub>	10,0	9,0	34,0	31,4	5,0	25
151212	12,0	G <sub>1/2</sub>	12,0	11,0	40,8	34,9	8,0	20
151412	14,0	G <sub>1/2</sub>	12,0	11,0	40,8	35,5	8,0	20

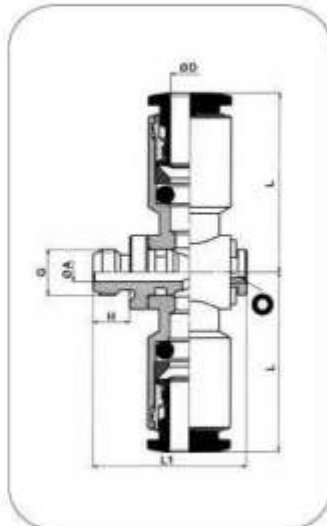
**ART. 16**

Asta con filetto maschio cilindrico in anello doppio  
Complete double banjo (rotating under pressure)

CODICE	ØD	G	ØA	H	L1	L	Ø	■
1604M5	4,0	M5	2,0	4,0	16,8	19,5	2,0	50
160418	4,0	G <sub>1/8</sub>	5,5	6,0	25,0	21,1	3,0	50
1605M5	5,0	M5	2,0	4,0	16,8	19,8	2,0	50
160518	5,0	G <sub>1/8</sub>	5,5	6,0	25,0	22,5	3,0	50
160618	6,0	G <sub>1/8</sub>	5,5	6,0	25,0	24,3	3,0	50
160614	6,0	G <sub>1/4</sub>	7,8	8,0	29,3	25,5	4,0	50
160818	8,0	G <sub>1/8</sub>	5,5	6,0	25,0	24,8	3,0	50
160814	8,0	G <sub>1/4</sub>	7,8	8,0	29,3	26,5	4,0	25
160838	8,0	G <sub>3/8</sub>	10	9,0	34	28	5,0	25
161014	10,0	G <sub>1/4</sub>	7,8	8,0	29,3	28,4	4,0	25
161038	10,0	G <sub>3/8</sub>	12	11,0	40,8	34,9	8,0	25
161238	12,0	G <sub>3/8</sub>	10,0	9,0	34,0	31,4	5,0	25

**ART. 19**

Raccordo ad elle fisso  
Elbow male adaptor

CODICE	ØD	G	ØB	E	L	■	■
190418	4,0	G <sub>1/8</sub>	9,0	18,6	16,5	10	100
190618	6,0	G <sub>1/8</sub>	11,0	23,8	16,5	10	100
190818	8,0	G <sub>1/8</sub>	13,0	25,5	18,5	11	100
190814	8,0	G <sub>1/4</sub>	13,0	25,5	22,0	11	100

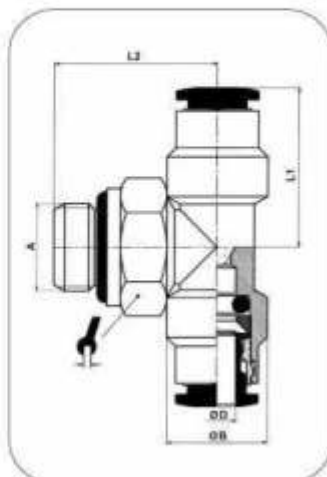
**ART. 20**



Raccordo a T centrale girevole  
Swivel male stud tee parallel

CODICE	ØD	A	ØB	L1	L2	■	■
2004M5	4,0	M5	9,0	17,3	20,0	8,0	50
200418	4,0	G <sub>1/8</sub>	11,0	17,3	18,5	13,0	50
200414	4,0	G <sub>1/4</sub>	9,0	19,0	22,5	16,0	50
200618	6,0	G <sub>1/8</sub>	11,0	20,6	18,5	13,0	50
200614	6,0	G <sub>1/4</sub>	11,0	22,1	22,5	16,0	50
200818	8,0	G <sub>1/8</sub>	13,0	23,0	20,5	13,0	50
200814	8,0	G <sub>1/4</sub>	13,0	23,0	22,5	16,0	50
200838	8,0	G <sub>3/8</sub>	13,0	24,5	25,5	18,0	25
201014	10,0	G <sub>1/4</sub>	16,0	26,4	24,5	16,0	25
201038	10,0	G <sub>3/8</sub>	16,0	26,4	25,5	18,0	25

**ART. 21** Raccordo a T laterale girevole  
Swivel male branch tee parallel

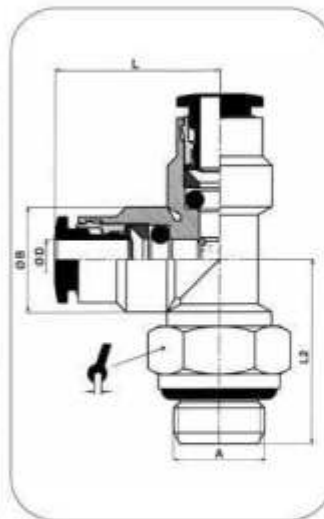
CODICE	ØD	A	ØB	L1	L2		
2104M5	4,0	M5	9,0	17,3	20,0	8,0	50
210418	4,0	G <sub>1/8</sub>	9,0	17,3	18,5	13,0	50
210414	4,0	G <sub>1/4</sub>	9,0	19,0	22,5	16,0	50
210618	6,0	G <sub>1/8</sub>	11,0	20,6	18,5	13,0	50
210614	6,0	G <sub>1/4</sub>	11,0	22,1	22,5	16,0	50
210818	8,0	G <sub>1/8</sub>	13,0	23,0	20,5	13,0	50
210814	8,0	G <sub>1/4</sub>	13,0	23,0	22,5	16,0	50
210838	8,0	G <sub>3/8</sub>	13,0	24,5	25,5	18,0	50
211014	10,0	G <sub>1/4</sub>	16,0	26,4	24,5	16,0	25
211038	10,0	G <sub>3/8</sub>	16,0	26,4	25,5	18,0	25

**ART. 22** Gomito girevole filetto cilindrico maschio con O-Ring  
Swivel elbow male adaptor parallel

CODICE	ØD	G	ØB	L1	L		
2204M5	4,0	M5	9,0	20,0	17,3	8,0	100
220418	4,0	G <sub>1/8</sub>	11,0	18,5	17,3	13,0	100
220414	4,0	G <sub>1/4</sub>	9,0	22,5	19,0	16,0	100
2206M5	6,0	M5	11,0	20,6	20,0	8,0	100
220618	6,0	G <sub>1/8</sub>	11,0	18,5	20,6	13,0	100
220614	6,0	G <sub>1/4</sub>	11,0	22,5	22,1	16,0	100
220818	8,0	G <sub>1/8</sub>	13,0	20,5	23,0	13,0	100
220814	8,0	G <sub>1/4</sub>	13,0	22,5	23,0	16,0	100
220838	8,0	G <sub>3/8</sub>	13,0	25,5	24,5	18,0	50
221014	10,0	G <sub>1/4</sub>	16,0	24,5	26,4	16,0	50
221038	10,0	G <sub>3/8</sub>	16,0	25,5	26,4	18,0	50
221214	12,0	G <sub>1/4</sub>	19,0	24,5	28,9	16,0	50
221238	12,0	G <sub>3/8</sub>	19,0	24,5	28,9	18,0	50
221212	12,0	G <sub>1/2</sub>	19,0	31,0	28,9	21,0	25
221438	14,0	G <sub>3/8</sub>	21,0	28,0	31,5	18,0	25
221412	14,0	G <sub>1/2</sub>	21,0	33,0	31,5	21,0	25

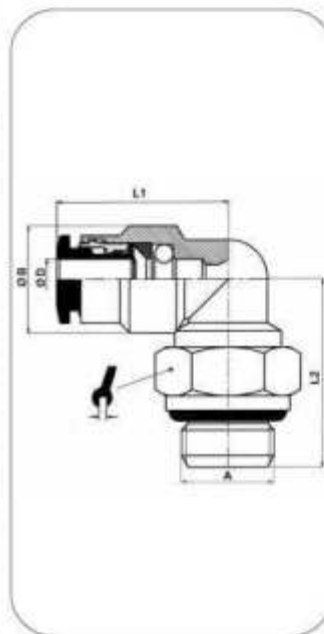
**ART. 25** Passaparete femmina  
Female bulk head

CODICE	ØA	ØB	C	D	E	L		CH1
250418	4,0	M10	G <sub>1/8</sub>	15,5	6,5	25,5	15	25
250618	6,0	M14	G <sub>1/8</sub>	15,8	6,5	26,8	15	25
250614	6,0	M14	G <sub>1/4</sub>	15,8	10	31,3	17	25
250818	8,0	M16	G <sub>1/8</sub>	16	6,5	29	17	25
250814	8,0	M16	G <sub>1/4</sub>	16	10	33,5	17	25

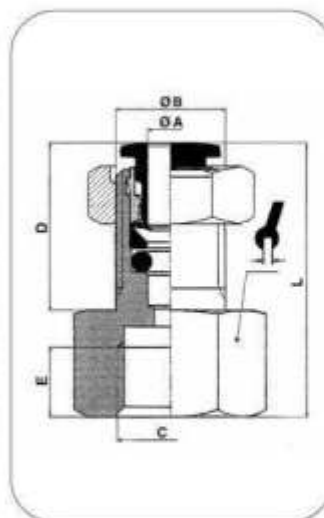



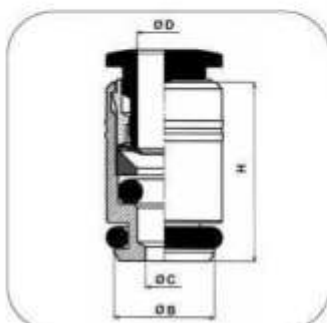

**ART. 27** Cartuccia per corpo di plastica  
Cartridge

CODICE	ØD	ØC	ØB	H		
270400	4,0	2,9	7,8	14,0		100
270600	6,0	5,0	10,0	16,0		50
270800	8,0	7,0	11,8	17,0		50

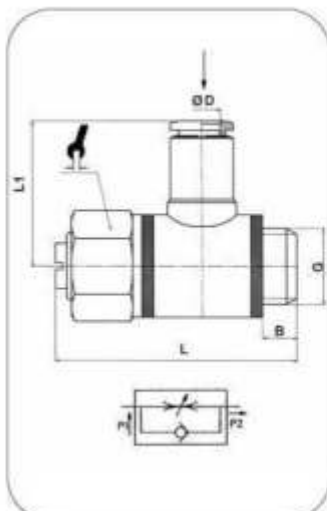

**ART. 28** Regolatore di flusso unidirezionale per valvola  
Unidirectional flow regulator for valve

CODICE	ØD	G	B	L <sub>1</sub>	L		
280418	4,0	G <sub>1/8</sub>	5,5	21,1	34,0	14,0	25
280518	5,0	G <sub>1/8</sub>	5,5	22,5	34,0	14,0	25
280618	6,0	G <sub>1/8</sub>	5,5	24,3	34,0	14,0	25
280614	6,0	G <sub>1/4</sub>	6,0	25,5	42,0	17,0	25
280818	8,0	G <sub>1/8</sub>	5,5	24,8	34,0	14,0	25
280814	8,0	G <sub>1/4</sub>	6,0	26,5	42,0	17,0	25
280838	8,0	G <sub>3/8</sub>	8,0	28,0	52,0	20,0	25
281014	10,0	G <sub>1/4</sub>	6,0	28,4	42,0	17,0	25
281038	10,0	G <sub>3/8</sub>	8,0	29,9	52,0	20,0	10
281238	12,0	G <sub>3/8</sub>	8,0	31,4	52,0	20,0	10
281212	12,0	G <sub>1/2</sub>	10,0	34,9	61,0	26,0	10

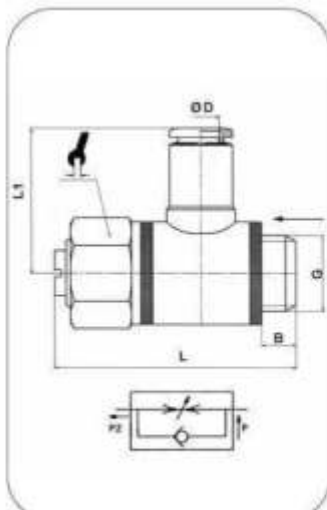

**ART. 29** Regolatore di flusso unidirezionale per cilindro  
Unidirectional flow regulator for cylinder

CODICE	ØD	G	B	L <sub>1</sub>	L		
290418	4,0	G <sub>1/8</sub>	5,5	21,1	34,0	14,0	25
290518	5,0	G <sub>1/8</sub>	5,5	22,5	34,0	14,0	25
290618	6,0	G <sub>1/8</sub>	5,5	24,3	34,0	14,0	25
290614	6,0	G <sub>1/4</sub>	6,0	25,5	42,0	17,0	25
290818	8,0	G <sub>1/8</sub>	5,5	24,8	34,0	14,0	25
290814	8,0	G <sub>1/4</sub>	6,0	26,5	42,0	17,0	25
290838	8,0	G <sub>3/8</sub>	8,0	28,0	52,0	20,0	25
291014	10,0	G <sub>1/4</sub>	6,0	28,4	42,0	17,0	25
291038	10,0	G <sub>3/8</sub>	8,0	29,9	52,0	20,0	10
291238	12,0	G <sub>3/8</sub>	8,0	31,4	52,0	20,0	10
291212	12,0	G <sub>1/2</sub>	10,0	34,9	61,0	26,0	10

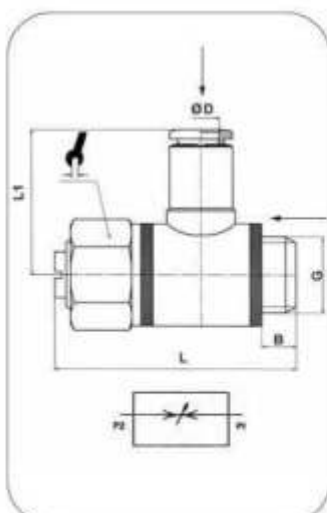



**ART. 30** Regolatore di flusso bidirezionale  
Bidirectional flow regulator

CODICE	ØD	G	B	L <sub>1</sub>	L		
300418	4,0	G <sub>1/8</sub>	5,5	21,1	34,0	14,0	25
300518	5,0	G <sub>1/8</sub>	5,5	22,5	34,0	14,0	25
300618	6,0	G <sub>1/8</sub>	5,5	24,3	34,0	14,0	25
300614	6,0	G <sub>1/4</sub>	6,0	25,5	42,0	17,0	25
300818	8,0	G <sub>1/8</sub>	5,5	24,8	34,0	14,0	25
300814	8,0	G <sub>1/4</sub>	6,0	26,5	42,0	17,0	25
300838	8,0	G <sub>3/8</sub>	8,0	28,0	52,0	20,0	25
301014	10,0	G <sub>1/4</sub>	6,0	28,4	42,0	17,0	25
301038	10,0	G <sub>3/8</sub>	8,0	29,9	52,0	20,0	10
301238	12,0	G <sub>3/8</sub>	8,0	31,4	52,0	20,0	10
301212	12,0	G <sub>1/2</sub>	10,0	34,9	61,0	26,0	10



**ART. 33**

 Anello doppio girevole con asta  
 Banjo stem double

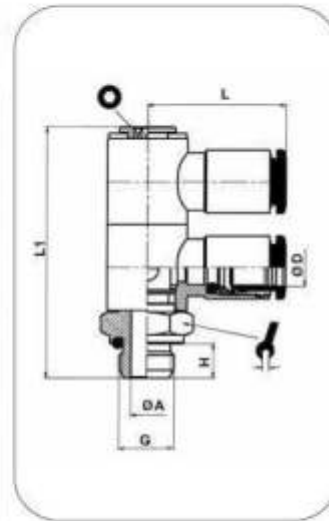
CODICE	ØD	G	ØA	H	L1	L			
330418	4,0	G <sub>1/8</sub>	5,5	6,0	43,8	21,1	14,0	3,0	25
330618	6,0	G <sub>1/8</sub>	5,5	6,0	43,8	24,3	14,0	3,0	25
330818	8,0	G <sub>1/8</sub>	5,5	6,0	43,8	24,8	14,0	3,0	25
330614	6,0	G <sub>1/4</sub>	7,8	8,0	51,5	25,5	18,0	4,0	25
330814	8,0	G <sub>1/4</sub>	7,8	8,0	51,5	26,5	18,0	4,0	25
331014	10,0	G <sub>1/4</sub>	7,8	8,0	51,5	28,4	18,0	4,0	25



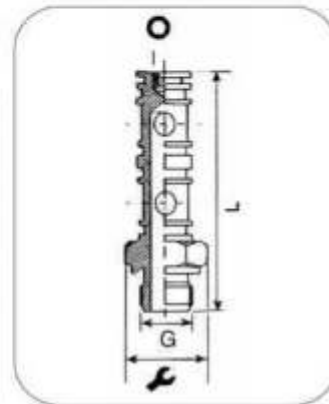

**ART. 33A**

 Asta doppia girevole  
 Banjo stem double

CODICE	G	L			
33A18	G <sub>1/8</sub>	43,8	14,0	3,0	50
33A14	G <sub>1/4</sub>	51,5	18,0	4,0	50

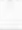

**ART. 34A**

 Asta tripla girevole  
 Banjo stem triple

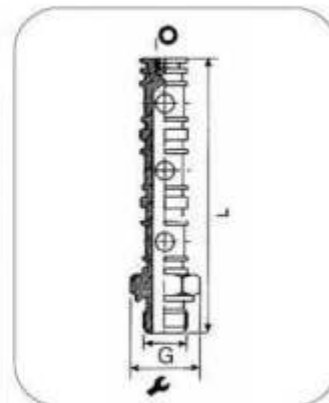
CODICE	G	L			
34A18	G <sub>1/8</sub>	59,0	14,0	3,0	50

**ART. 60**

 Innesto prolungato filetto cilindrico con O-Ring  
 Adaptor parallel long

CODICE	ØD	G	ØC	ØB	H	L	ØA		
600418	4,0	G <sub>1/8</sub>	2,0	13,0	6,0	39,2	6,0	13,0	50
600618	6,0	G <sub>1/8</sub>	4,0	13,0	6,0	43,5	6,0	13,0	50
600614	6,0	G <sub>1/4</sub>	4,0	16,0	8,0	46,0	7,5	13,0	50
600818	8,0	G <sub>1/8</sub>	6,0	13,0	6,0	47,0		13,0	50
600814	8,0	G <sub>1/4</sub>	6,0	16,0	8,0	49,5	7,5	13,0	50
600838	8,0	G <sub>3/8</sub>	6,0	20,0	9,0	51,5	9,0	13,0	50
601014	10,0	G <sub>1/4</sub>	8,0	16,0	8,0	55,5		13,0	50
601038	10,0	G <sub>3/8</sub>	8,0	13,0	9,0	57,5	9,0	13,0	25

