

Construction and working characteristics

- Diaphragm pressure regulator with relieving.
- Balanced poppet.
- Lockable handle by simply pressing it downwards in the desired position.
- Body made with light alloy.
- Wall mounting possibility with M5 screws protected by covers.
- Two pressure gauge connections with plug complete of seal.
- Panel mounting bracket.

Technical characteristics

Connections	G 1/4" - G 3/8"
Max. inlet pressure	13 bar - 1,3 MPa
Max. ambient temperature	50°C
Pressure gauge connections	G 1/8"
Weight	gr. 390
Pressure range	0 - 2 bar
	0 - 4 bar
	0 - 8 bar
	0 - 12 bar
Assembly position	Any
Wall fixing screws	M5
Max. fitting torque	25 Nm

Flow rate curves

Inlet pressure (7 bar)

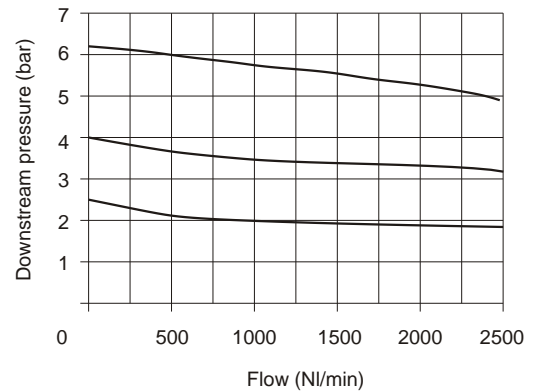

Adjustment characteristics

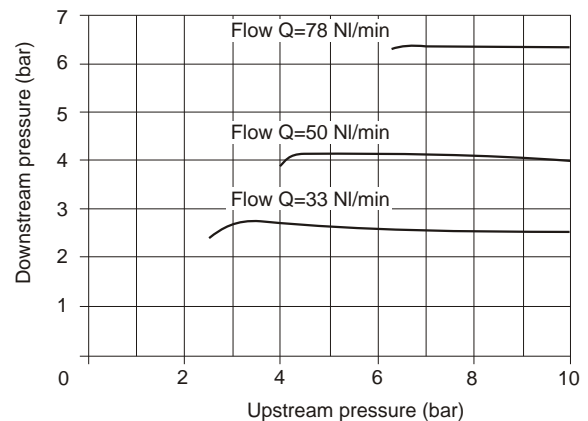

Ordering code

17202

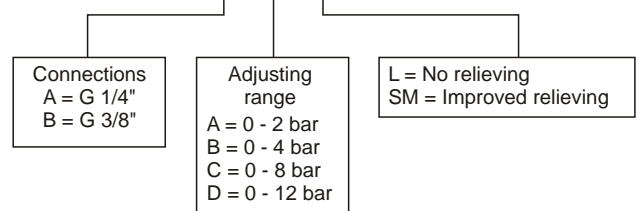

Example: **17202A.C**
Pressure regulator with G 1/4" connections, adjusting range 0 - 8 bar with relieving.

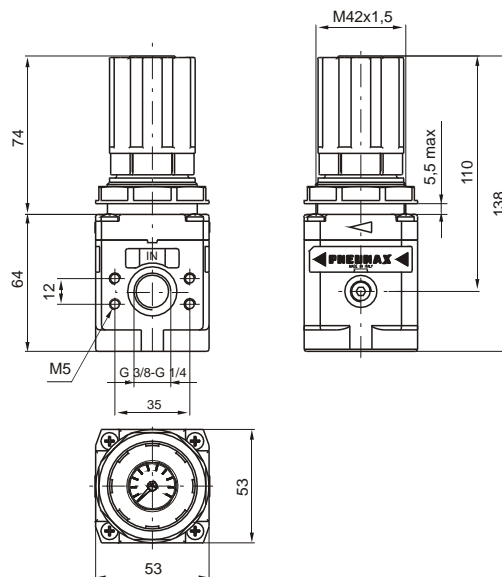

Construction and working characteristics

- Diaphragm pressure regulator with relieving.
- Pressure gauge included on the top of adjusting knob.
- Balanced poppet.
- Lockable handle by simply pressing it downwards in the desired position.
- Body made with light alloy.
- Wall mounting possibility with M5 screws protected by covers.
- Panel mounting bracket.

Technical characteristics

Connections	G 1/4" - G 3/8"
Max. inlet pressure	13 bar - 1,3 MPa
Max. ambient temperature	50°C
Pressure gauge connections	G 1/8"
Weight	gr. 440
Pressure range	0 - 2 bar
	0 - 4 bar
	0 - 8 bar
	0 - 12 bar
Assembly position	Any
Wall fixing screws	M5
Max. fitting torque	25 Nm

Flow rate curves

Inlet pressure (7 bar)

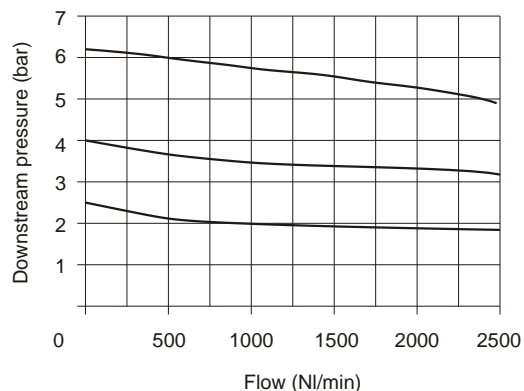

Adjustment characteristics

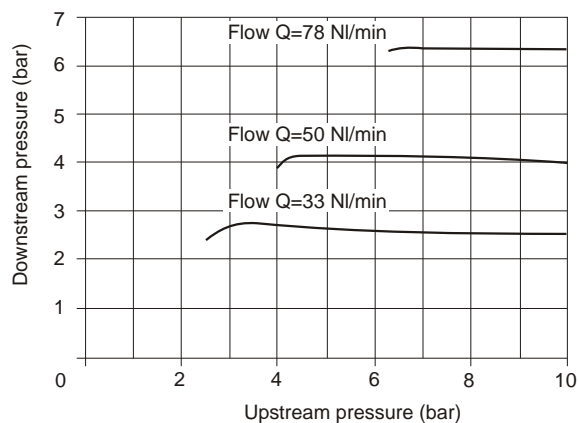

Ordering code

17222

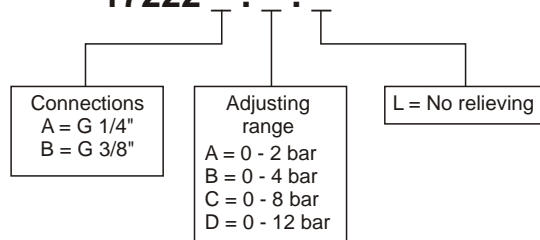

Example: **17222A.C**
Pressure regulator with G 1/4" connections, adjusting range 0 - 8 bar with relieving.